

BRIO TANK

Features

- It automatizes the start of the electric pump after a pressure decrease (taps opening) and its stop when the fluid flow interrupts at the maximum pressure level of the electric pump (taps closing).
- It completely replaces the traditional water system with pressure switch and pressure tank.
- A small 0,4 l water tank is integrated and it prevents frequent start and stop of the pump in case of small request of water and in case of leakages on the installation.
- Replaceable BUTYL bladder of the pressure tank.
- Adjustable pre-charge pressure (factory setting 1,5 bar) of the pressure tank.
- Integrated pressure gauge.
- Protection against dry running and water hammering.
- Adjustable starting pressure.
- Installation in any position - both vertical and horizontal.
- Electronic board with protecting conforme coating placed in a waterproof compartment against water condensation.
- Automatic reset up to 10 attempts.
- 24h hour anti-block protection.
- Inspectionable check valve minimum flow \approx 3.5 lt/min
- Pressure drops: 1,2 bar at 150 Lt/min.



TECHNICAL DATA

Alimentazione Power supply	115-230Vac \pm 15% 50/60Hz
Corrente max Max rated current	12A (2HP) 1500 W
Campo pressione di intervento Starting pressure range	1+3,5 bar (1,5 bar factory setting)
Pressione max ammissibile Max allowable pressure	10 bar
Grado di protezione Protection degree	IP 65
Temperatura liquido Fluid temperature	5°C+35°C
Temperatura ambiente Ambient temperature	5°C+45°C
Connessione idraulica Hydraulic connection	1" M

BRIO

Features

- It automatizes the start of the electric pump after a pressure decrease (taps opening) and its stop when the fluid flow interrupts at the maximum pressure level of the electric pump (taps closing).
- It completely replaces the traditional water system with pressure switch and pressure tank.
- Automatic reset up to 10 attempts.
- 24h hour anti-block protection.
- New inspectionable check valve minimum flow \approx 2,5 lt/min.
- Protection against dry running.
- Adjustable starting pressure.
- Installation in any position - both vertical and horizontal.
- Easily replaceable electronic printed circuit board.
- No need of maintenance.
- Installation in a by-pass mode.
- Pressure drops: 1 bar at 150 lt/min



TECHNICAL DATA

Alimentazione Power supply	115-230Vac \pm 15% 50/60Hz
Corrente max Max rated current	12A (2HP) 1500 W
Campo pressione di intervento Starting pressure range	1+3,5 bar (1,5 bar factory setting)
Pressione max ammissibile Max allowable pressure	10 bar
Grado di protezione Protection degree	IP 65
Temperatura liquido Fluid temperature	5°C+55°C
Temperatura ambiente Ambient temperature	5°C+45°C
Connessione idraulica Hydraulic connection	1" M

PM PT

Features

- Pressure switches for booster sets.
- The switch automatically ensures the start and stop functions of the electric pump according to the set pressure values.
- Electric contacts: normally closed and made of brass alloy with Ag-Ni surfacing.
- NBR white membrane with insert in PA (nylon).
- ¼" F hydraulic connection made of galvanized steel.
- Tear resistant cable clamps.
- Terminal block with full insulated live parts.



TECHNICAL DATA

	PM5	PM6	PM12	PT5	PT6	PT12
Campo di regolazione Pressure range	1+4,8 bar	1,5+5,5 bar	3+12 bar	1+4,8 bar	1,5+5,5 bar	3+12 bar
Taratura di fabbrica Factory setting	1,4-2,8 bar	1,8-3 bar	5-7 bar	1,4-2,8 bar	1,8-3 bar	5-7 bar
Differenziale minimo Min differential	0,6 bar	0,8 bar	1,5 bar	0,6 bar	0,8 bar	1,5 bar
Differenziale massimo Max differential	2,3 bar	2,2 bar	5 bar	2,3 bar	2,2 bar	5 bar
Corrente nominale Rated current	16(10)A					
Tensione nominale Rated voltage	250V			500V		
Grado di protezione Protection degree	IP 44					
Temperatura del fluido Fluid temperature	5°C+55°C					
Temperatura ambiente Ambient temperature	5°C+55°C					



Italtecnica S.r.l.

Viale Europa, 31 - 35020 Tribano - Padova (PD) - Italy

Tel. +39 049 9585388 - Fax +39 049 5342439

italtecnica@italtecnica.com

www.italtecnica.com



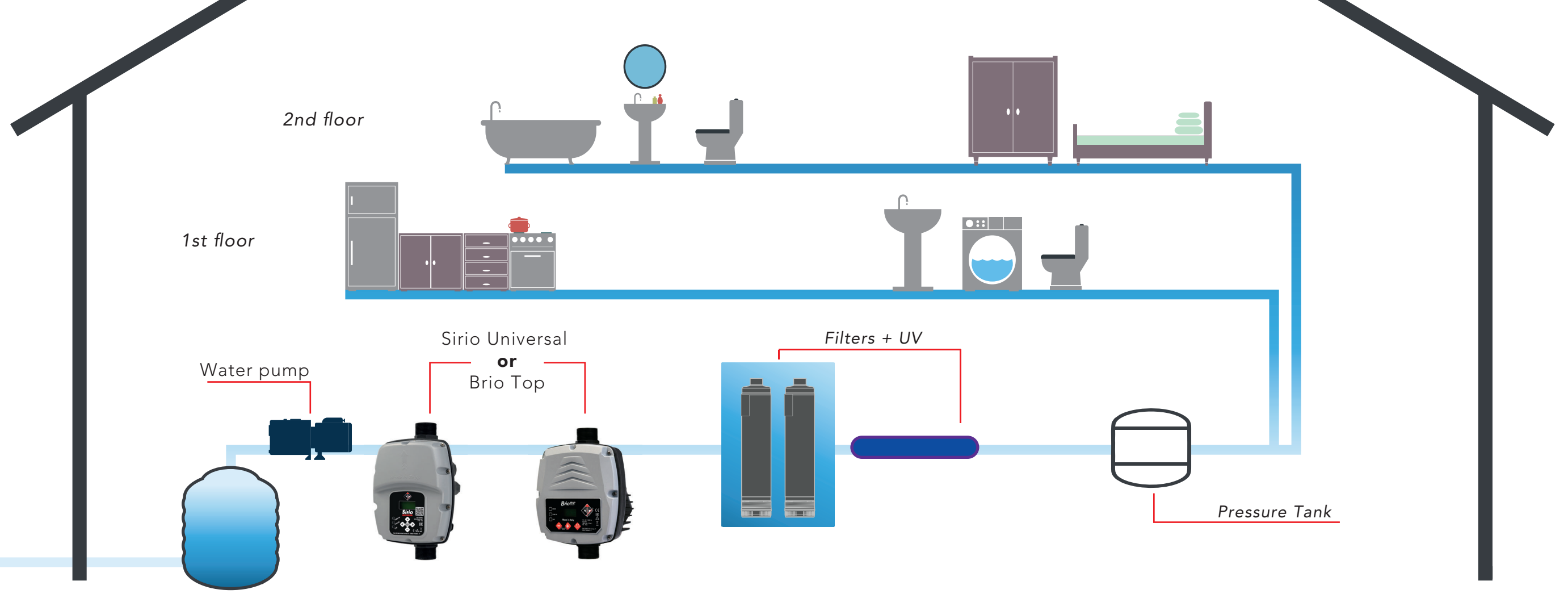
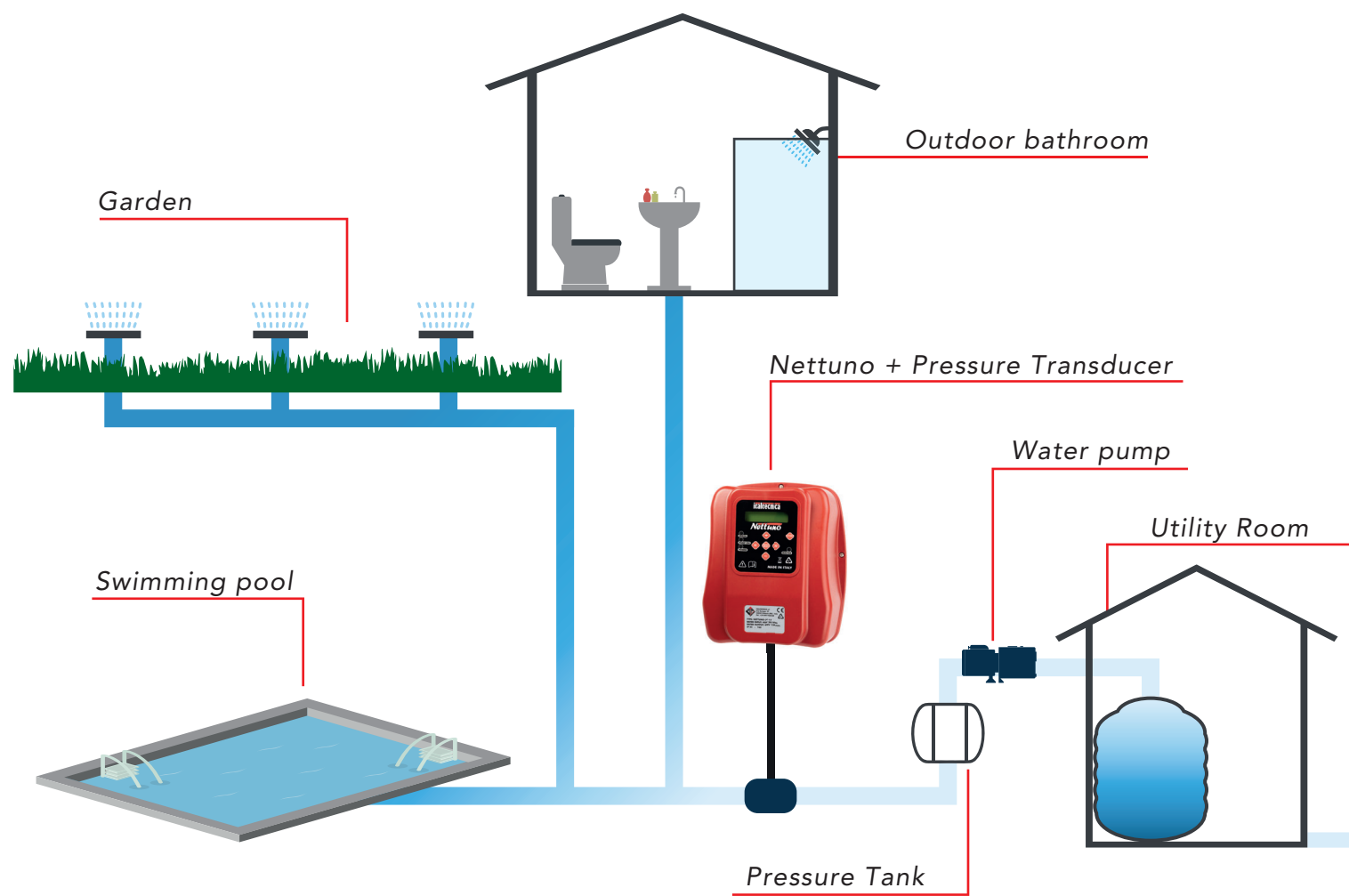

NETTUNO



Features

- Nettuno is an electronic device which controls traditional electric pump (surface and submersible). It is based on **inverter technology** and according to the water need it can modulate the motor's input current adjusting the pump speed.
- Motor output **current control**.
- **Constant pressure** due to motor pump speed regulation.
- **Energy saving** due to less pump absorption.
- Gradual start and stop functions of the pump reduce hammering (SOFT-START).
- Protection **against dry running**.
- Automatic reset in event of dry running.
- Leakages monitoring.
- Anti-blocking function.
- Possibility to connect more drives to a booster set up to 8 pumps.
- Extended menu for an advanced configuration.
- Necessary installation of a pressure tank.
- Multilingual display with 16 characters.

Optionals – special arrangements

- Kit of fixing collars for horizontal pipe. Available sizes 1" - 1 1/2" - 2" - 2 1/2".
- Pressure transducer 4+20mA to be connected to the system delivery. In a booster system with more pumps a single transducer is sufficient to be connected to any one of the inverters.

Installazione/Installation PIPELINE INSTALLATION

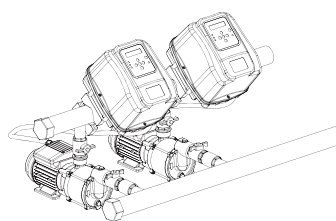

TECHNICAL DATA

	NETTUNO 3P-13A	NETTUNO UNIVERSAL
Alimentazione di rete Power mains supply	Trifase / Three-phase 400Vac±15% - 50/60Hz	Monofase / Single-phase 230Vac±15% - 50/60Hz
Uscita motore / Potenza Massima Motor power output / Max motor power	Trifase / Three-phase 400Vac / 13A	1x230V - 10,5A max 3x230V - 9,7A max (selectable)
Raffreddamento Cooling	Ventilazione forzata aria Forced air ventilation	
Ingressi analogici Analog inputs	4+20mA (sensore pressione/ pressure sensor) 0+10V (aux.)	
Ingressi digitali Digital inputs	3 inputs (enable, error, 2° set-point)	
Uscite digitali Digital outputs	2 relays (funzioni programmabili / programmable functions)	1 relay (funzioni programmabili / programmable functions)
Gruppi di pressurizzazione Booster sets	Fino a 8 pompe / Up to 8 pumps	
Temperatura ambiente Ambient temperature	5 °C+45°C	
Grado di protezione Protection degree	IP44	

SIRIO UNIVERSAL - SIRIO UNIVERSAL XP



Features

- It controls the start and stop functions of the traditional electric pump (surface and submersible) and modulates the motor rotations according to the water request from the system. Hammering is reduced and inrush starting current avoided.
- **Constant pressure**.
- **Integrated pressure transducer**.
- Possibility to **disable the flow sensor** if the water is not perfectly clean or ferrous.
- **Energy saving**.
- **Protection against dry running**.
- **Automatic reset** in event of dry running.
- **Protection against leakages, over pressure, over heating, rotor blocking and abnormal power supply**.
- **Motor over current control**.
- **Digital indication of the pressure, motor frequency, voltage and current**.
- **Adjustment of the frequency with temperature's increasing**.
- **Programmable input and output for different functions (enable, double set-point, error, function in twin booster sets)**.
- **Multilingual display with 16 characters**.
- **Pressure drops: 0,05 bar at 150L/min**

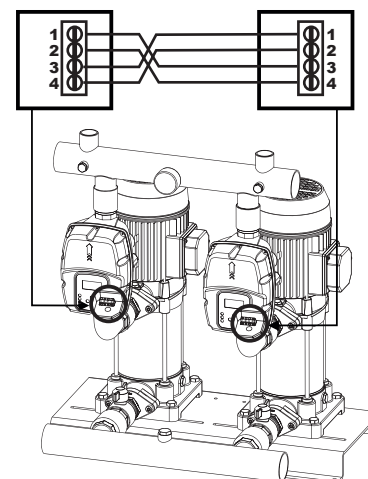

TECHNICAL DATA

	SIRIO UNIVERSAL	SIRIO UNIVERSAL XP
Alimentazione di rete Power mains supply	230Vac ±15% 50/60Hz	
Uscita motore Motor power output	monofase 220V - single phase 220V trifase 230V - three phase 230V (selezionabile/selectable)	
Potenza massima motore Max motor power	1x220V - 2Hp - 10,5A 3x230V - 3Hp - 9,7A	1x220V - 2,4Hp - 14A 3x230V - 3Hp - 9,7A
Pressione massima ammissibile Max allowable pressure	800 KPa (8 bar)	
Temperatura liquido Fluid temperature	5 °C+45°C	
Campo regolazione set-point Set-point adjustment range	0,5+8 bar (Pmax 3 bar - Dp.start 1 bar factory setting)	
Connessione idraulica Hydraulic connection	maschio-maschio 1" 1/4 male-male 1" 1/4	
Temperatura ambiente Ambient temperature	5 °C+45°C	
Grado di protezione Protection degree	IPX5	

Si consiglia l'uso di un vaso di espansione
We suggest to install a pressure tank.

BRIO TOP



Features

- Suitable for water pumping systems with pressure tank as **digital pressure switch**, or as **flow and pressure controller**.
- Pressure values and motor current showed on the display.
- Pressure values adjustable via digital display.
- Automatic control of the start and stop functions of **single phase electric pumps** (surface and submersible) up to 16A (3 HP).
- **Protection against dry running**.
- **Automatic reset** in event of dry running.
- **Motor over current control** which trips in the event of overload or with the blocked rotor.
- **Anti-freeze protection** which starts up the pump when the ambient temperature falls below 4°C.
- **Rotor anti-blocking function** used to prevent seizure of mechanical parts during prolonged periods of pump inactivity.
- **Overpressure protection** able to stop the electric pump at a set threshold.
- **Installation in any position - both vertical and horizontal**.
- **Operation in master/slave configuration into twin booster sets**.
- **Terminals for remote connection** (1 input + 1 output).
- **Alarm log** for simple analysis of any system malfunctions.
- **Severe teak protection** (starts check per hour 15-30-60).
- Possibility to place the pump capacitor inside (lt 130 Ø 50).
- **Multilingual display with 16 characters**.
- **Pressure drops:**
1" 0.4 bar 150 lt/min
1" 1/4 -0.3 bar 150 lt/min

TECHNICAL DATA

Alimentazione Power supply	115-230Vac ±15% 50/60Hz
Corrente max Max rated current	16A
Campo pressione d'intervento (modalità P+F) Starting pressure range (P+F mode)	0,5+8 bar (1,5 bar factory setting)
Campo di regolazione (modalità P+P) Pressure range (P+P mode)	0,8+9 bar (Pmin 1,5 bar - Pmax 3 bar factory setting)
Pressione max ammissibile Max allowable pressure	10 bar
Grado di protezione Protection degree	IP 65
Temperatura liquido Fluid temperature	5°C+45°C
Temperatura ambiente Ambient temperature	5°C+45°C
Connessione idraulica Hydraulic connection	1" M o 1" 1/4 M

